

# FROM BELPER TO A BALI BEACH

**Sustainable plans** Innovation, conservation and energy efficiency – these are the watchwords for architects of high-class developments throughout the world

**What** The Old London Park Hotel

**Where** Elephant & Castle, London SE17

**Who Developer:** First Base

**Architect:** Rogers Stirk Harbour & Partners

**Why** The planned demolition of the derelict London Park Hotel will make way for a 43-storey iconic architectural structure linked to a series of terrace blocks overlooking St Mary's churchyard, delivering up to 470 new homes and a new public square. The development will include a café and new home for Southwark Playhouse. Alongside the scheme, the preservation of the cycle path between the old London Park Hotel site and Churchyard Row will provide additional recreational areas for residents.



LIGHT HOUSE PHOTO: STEVE TOWNSEND



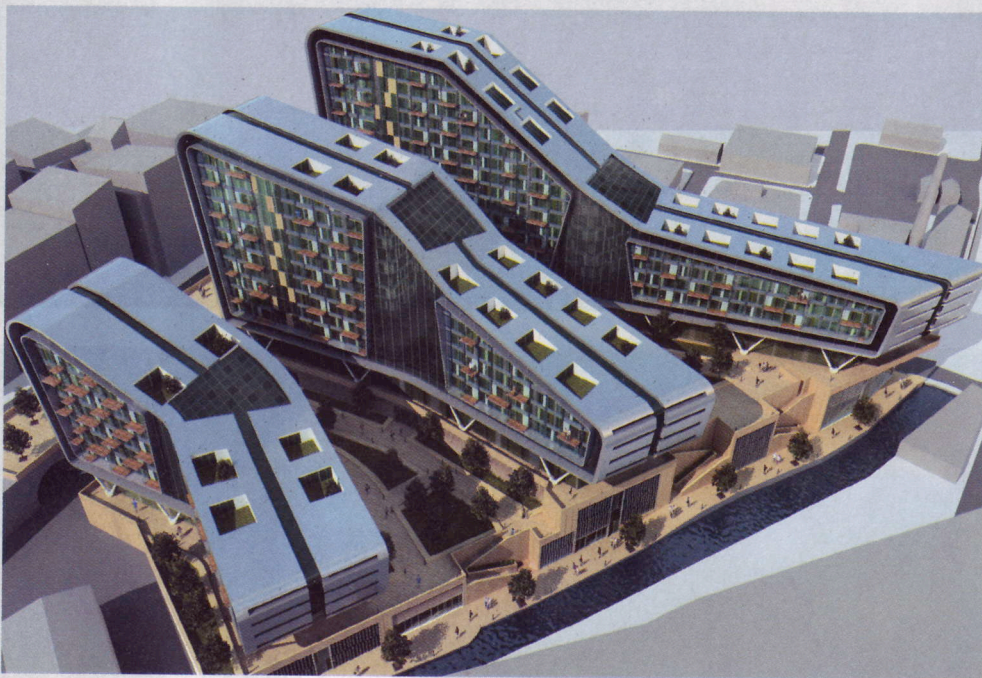

**What** River Irk housing  
**Where** Near Victoria station,  
Manchester

**Who Developer:** Satnam Investments, Cheltenham  
**Architect:** Reid Architecture (changing to 3DReid from 1 July)  
**Why** The £70m mixed-use project on a 2.6-acre site is mainly residential with 500 units, complemented by 35,000 sq ft of

commercial space and up to 630 car parking spaces. The residential units comprise 20% one-bed, 70% two-beds and 10% three-beds. The development is split into three "fingers" that rise in height from the banks of the River Irk at the south-eastern boundary towards a high point of 60m at the most northerly end of the site. Work may start as soon as spring 2008.

**What** The Light House

**Where** Belper, Derbyshire  
**Who Architect:** Hudson Architects  
**Structural engineer:** Techniker  
**Landscape designer:** Diarmuid Gavin

**Why** Built into the Derbyshire hillside, the four-bedroom house commissioned by private client Jackie Lee is divided into three zones, with all reception rooms located on the ground floor. With its northerly side built into the rock of the hill, the building becomes progressively "lighter" towards the south elevation, moving from local solid red stone, to timber and then glass. The "cut from the rock" analogy continues in the master bathroom, where walls and floor are stone clad and the bath and utilities embedded in a red stone plinth. The living space includes a dramatic two-storey sun lounge and balconies. Fully glazed walls offer 180-degree views over the valley and town below, and there is oak flooring throughout.