



AJ

# SPECIFICATION

## LIGHTING

Hudson Architects  
FaulknerBrowns  
John Puttick Associates



# DISS CORN HALL BY HUDSON ARCHITECTS

Photography by Joakim Boren



Diss Corn Hall was built in 1854, occupying a prominent position in the Norfolk town's historic centre. Today the Grade II-listed building is a leading East Anglian arts venue, operated by the Diss Corn Hall Trust.

Hudson Architects has carried out a £1.7 million refurbishment and extension of the hall, supported by the Heritage Lottery Fund. This has reinstated historic elements of the building, provided flexible support spaces and created additional space for heritage presentation and education.

The Corn Hall has been given a new entrance, approached from the street through a forecourt. A modern extension, which replaces the 1970s infill building, provides a new fully accessible public entrance and a double-height lobby containing a light and airy bar area and box office together with improved back-of-house facilities.

A former stable to the rear now becomes a gallery, with additional display space on the extension's wide first-floor landings. The main hall's historic features have been restored, with major improvements to ventilation, acoustics, seating and lighting to bring it up to date as a performance venue. Other rooms have also been upgraded to provide high-quality spaces for meetings or small events.

*Sandra Muller, project architect, Hudson Architects*



Location plan

0 10m ↑











Artemide®

artemide.com

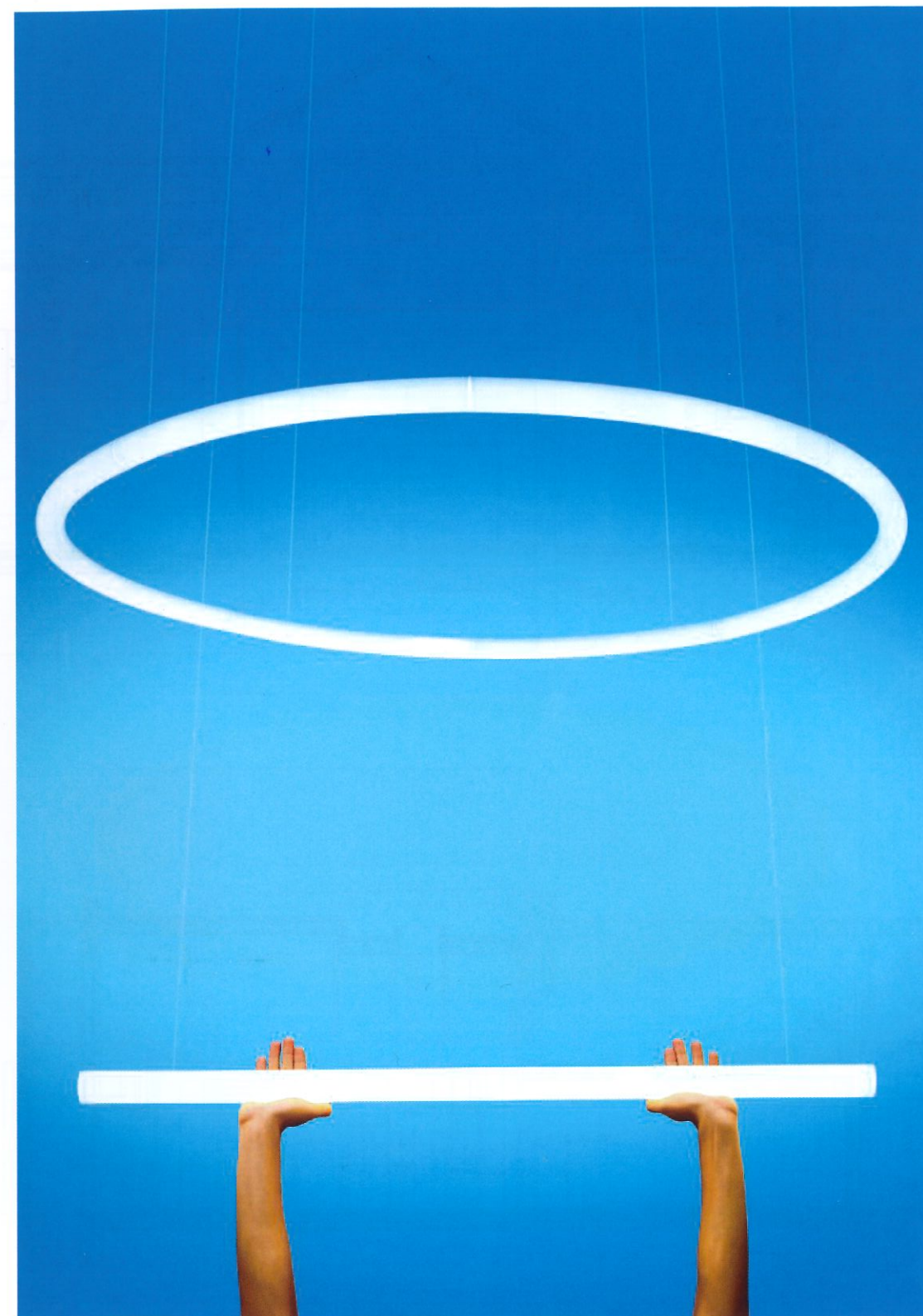

Alphabet of light  
BIG

Pierpaolo Ferrari, 2017







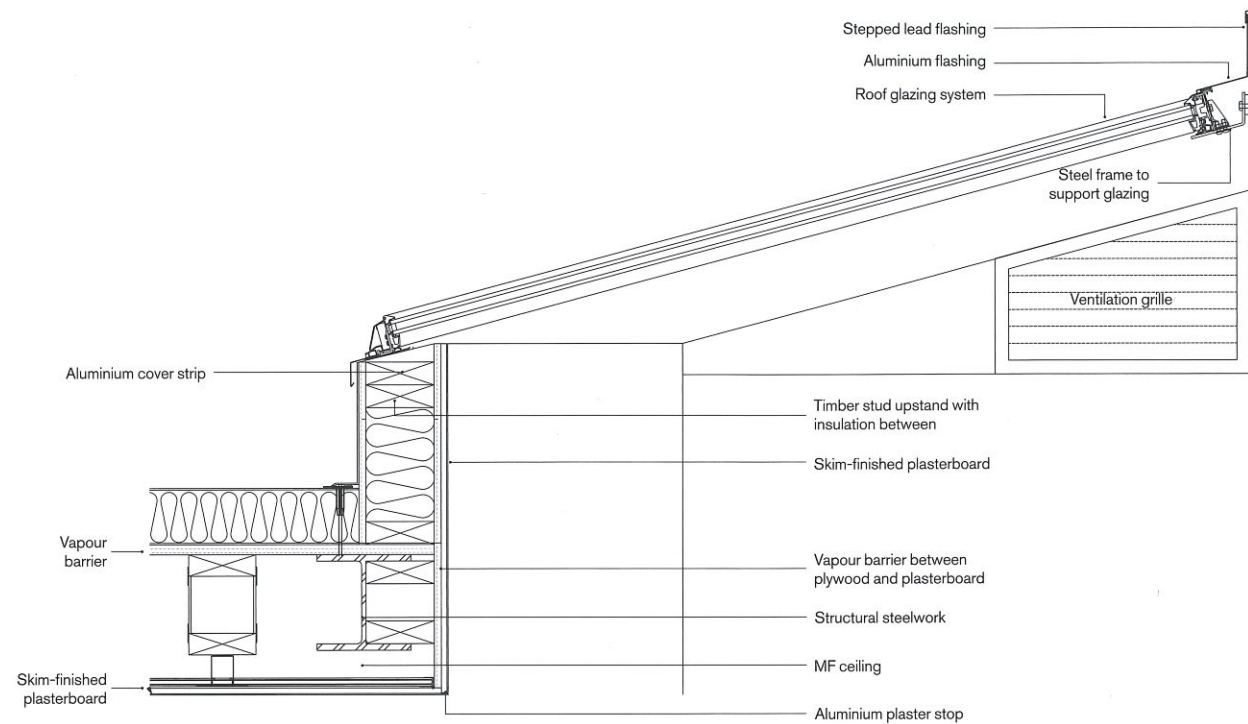

Detail section through rooflight

0 0.2m

### Specification statement

In its time, the Corn Hall was considered to be at the forefront of technology, with a cast-iron roof structure and rows of tall glazed lanterns covering 17 skylights which filled the trading hall with diffused light. These, however, had been replaced with unsympathetic 1970s rooflights of much smaller proportions than the originals. Large shutters beneath the rooflights, to black out light during performance, could not be opened, forcing the need for artificial lighting, even during daytime.

Hudson Architects has inserted 12 light boxes of the same proportions as the original rooflights between the existing cast-iron beams. These are formed using acoustically absorbent

fabric with the lighting behind it, creating a glowing box that can both simulate daylight and deliver mood lighting for other events, allowing flexibility in use. New performance lighting rigs have also been installed.

Elsewhere, rooflights to the council chamber on the first floor have been retained and restored. In addition to the artificial lighting, careful consideration has been given to daylighting, in particular in the new extension where a large rooflight floods the lobby and bar area beneath with natural light and also brings daylight into new display and circulation areas on the first-floor landing.

*Sandra Muller, project architect,  
Hudson Architects*



## FIRE DOORS COMBINING SAFETY & ARCHITECTURAL STYLE

Why should function win over form? The Tekno Door proudly balances modern minimalist aesthetics alongside crucial fire protection. Hanging elegantly from its concealed hinge, it closes flush with the wall, and its drop-down threshold and smoke seals completely close the gap between the door and frame in the event of a fire. Rated EI 120 for up to 120 minutes of fire resistance, as a fire door set Tekno not only protects interior spaces but adds aesthetic value to them.



bluebellproducts.co.uk | 01371 873334 | info@bluebellproducts.co.uk

**BLUEBELL**  
ARCHITECTURAL & DESIGN PRODUCTS



# SAMPLES BOARD

Photographed by Ståle Eriksen

1. **Paint**  
Dulux Chalky Downs 6  
[www.dulux.co.uk](http://www.dulux.co.uk)
2. **Paint**  
Little Greene Shirting 129  
[www.littlegreene.com](http://www.littlegreene.com)
3. **Paint**  
Dulux Warm Pewter  
[www.dulux.co.uk](http://www.dulux.co.uk)
4. **Paint**  
Farrow + Ball Brassica  
[www.farrow-ball.com](http://www.farrow-ball.com)
5. **Fabric to acoustic panels**  
Ecosorba  
Camira, Lucia range, colour Tequila YB038  
[www.ecosorba.co.uk](http://www.ecosorba.co.uk)
6. **Code door handle**  
Union  
E1200 code handle, satin stainless steel with satin chrome trim  
[www.uniononline.co.uk](http://www.uniononline.co.uk)
7. **Roofing membrane**  
Sarnafil, Lead Grey  
[gbr.sarnafil.sika.com](http://gbr.sarnafil.sika.com)
8. **Bricks**  
Ibstock  
Leicester Red Stock  
[www.ibstock.com](http://www.ibstock.com)
9. **Ironmongery**  
Carlisle Brass butt hinge  
Florentine Bronze  
[www.carlislebrass.com](http://www.carlislebrass.com)
10. **Wood Oil**  
Osmo  
Polyx Oil 3075 Black  
[www.osmouk.com](http://www.osmouk.com)
11. **Wood Oil**  
Osmo  
Polyx Oil 3032 Clear Satin  
[www.osmouk.com](http://www.osmouk.com)
12. **Engineered timber flooring**  
Bausen  
Hardwax oiled  
[www.bausen.co.uk](http://www.bausen.co.uk)
13. **Entrance Matting**  
Forbo  
Coral classic 4721  
[www.forbo.com](http://www.forbo.com)

